



## EHV metal high-voltage connector



Product Performance	
Lifespan	≥ 200 cycles
Insertion/Extraction Force	< 100N
Cable Range	35 to 50mm <sup>2</sup> Shielded Cable
Rated current	Max 200A
Rated voltage	1000V DC
Withstand voltage	3000VAC
Salt Spray Test	48 hours

Product Performance	
Insulation resistance	≥200MΩ (DC1000V)
Temperature Rise	≤ 55K
EMI Protection	360° Shielding
Protection class	IP67 (Connected)
Working temperature	-40°C to 125°C
Housing	PA66
Flame retardant grade	UL94V0

**EHV metal high-voltage connector**, with a maximum current of 200A and suitable for crimping 35 to 50mm<sup>2</sup> cables, is a reliable connection solution for electric and hybrid vehicles.

Features:

- Built-in HVIL;
- Maximum rated current of 200A;
- Bolt locking/unlocking;
- Protection class IP67 (after mating);
- Finger protection design;
- Three types of keying options to prevent misinsertion.

**EHV Metal 2-pin Plug Dimensions**

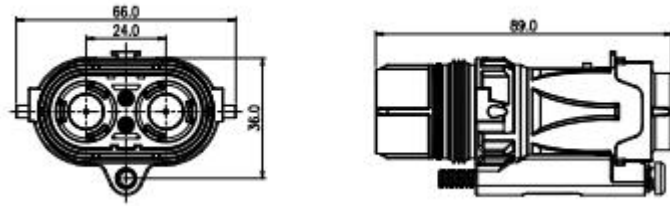

**EHV Metal 2-pin Receptacle Panel Mounting Dimensions**

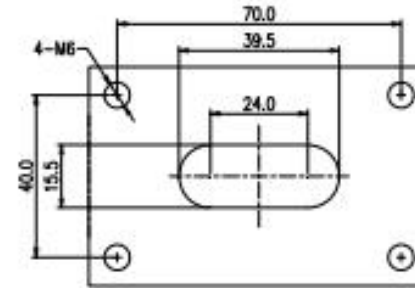

**EHV Metal 2-pin Plug Keyway Selection**

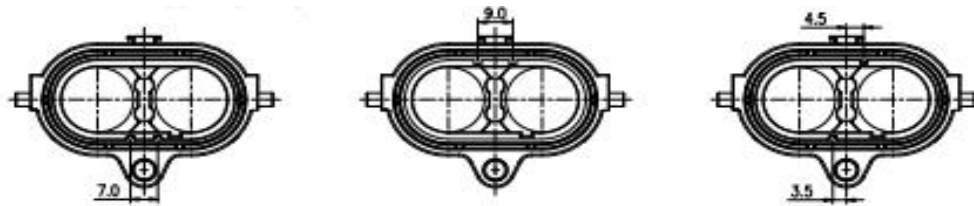

X Key Position

Y Key Position

Z Key Position

**EHV Metal 2-pin Receptacle Keyway Selection:**

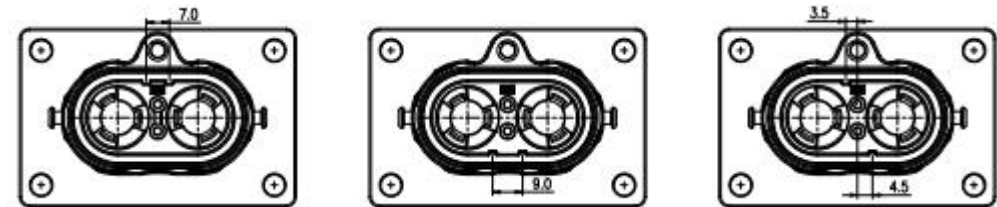

X Key Position

Y Key Position

Z Key Position

**EHV Metal 2-pin Receptacle Dimensions:**

